

## Product Installation Guidelines

Version 1, 10 July 2024, Page 1 of 4  
Document No.: 001.00.70.15

# Ezy-Wash® CP-BS Lead Safe™ Lever Action Twin Mixer Set

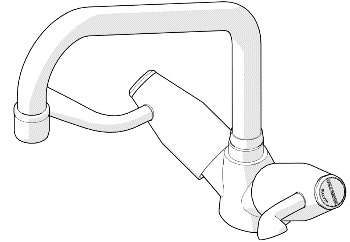

PRODUCTS					
Item Code	Description	WELS Rating	Water Consumption	Nominal Flow Rate	Outlet
181.20.10.00	Ezy-Wash CP-BS Lead Safe™ L/Action Twin Mixer Sink Set C/D with 200 Upswept Spout & 80 Lever	5	5.0	4.85	Tube Nozzle
181.20.11.00	Ezy-Wash CP-BS Lead Safe™ L/Action Twin Mixer Sink Set C/D with 300 Upswept Spout & 80 Lever	5	5.0	4.85	Aerator

## SPECIFICATIONS

- Galvin Engineering recommends the installation of strainers and pressure reducing valves prior to installing the pre-rinse unit to ensure clean consistent water supply. Debris or poor water quality could cause the trigger to seize or fail to seal.
- Lead Safe™ brass construction. \*

**IMPORTANT:** All Ezy-Wash® Food Service taps are tested in accordance with AS/NZS 3718 and leave our premises in good working order.

\*Our Lead Safe™ product range is compliant with the Lead-Free Requirements of the NCC 2022 Vol. Three, Clause A5G4(2) and NSF/ANSI 372.

\*\* Any flow controller incorporated in the outlet to be tightened to prevent removal by hand. As Per AS3718.

**WARNINGS:** Special attentions to be paid on notes, photos, images, or drawings of assembly steps marked with the warning symbol.



## TECHNICAL DATA

Inlet		G ½" – Female Flexi Tail
Outlet		Aerator
Headworks		Ceramic Disc
Working Pressure Range (kPa)	Min	50
	Max	500
Working Temperature Range (°C)	Min	5
	Max	65
Construction		Brass
Finish		Chrome
<b>NOTE:</b> Galvin Engineering continually strives to improve their products. Specifications may change without notice		

## TOOLS REQUIRED

- Adjustable spanner
- Hex key
- Power drill

## PRE-INSTALLATION

### Body

- If the mounting hole does not already exist, mark out and drill the hole in the bench, as shown.
- This model is a single inlet unit requiring a hole diameter of 31mm - 35mm.
- Maximum bench thickness is 45mm.

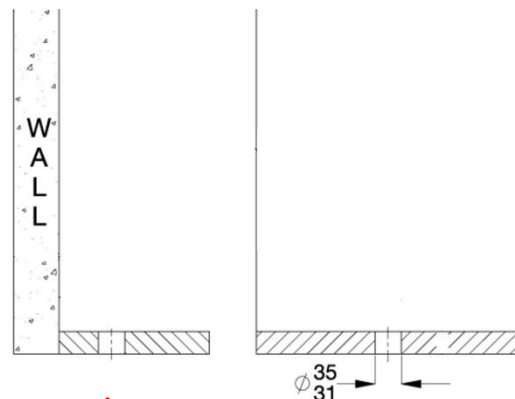

**MOUNTING DETAILS**

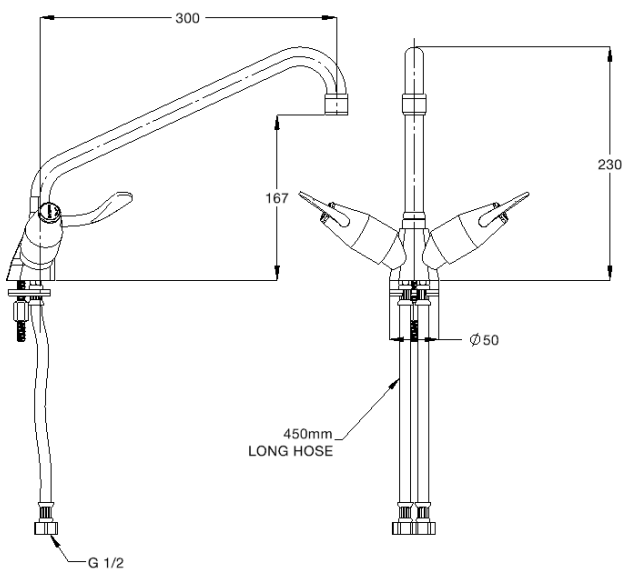

**181.20.11.00**

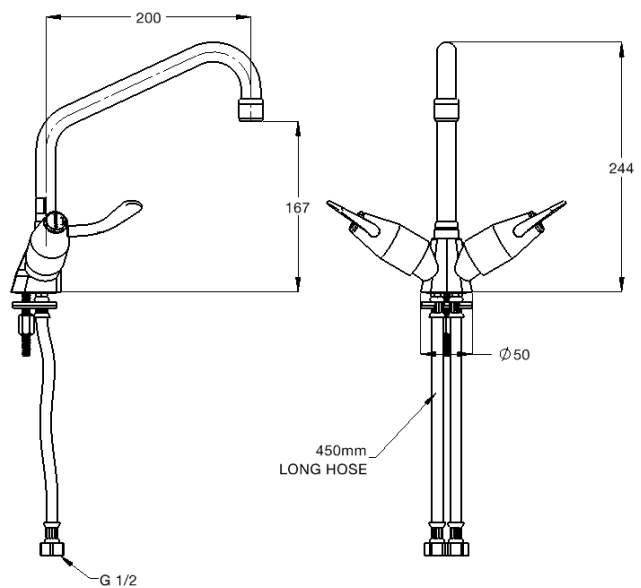

**181.20.10.00**

## INSTALLATION

**INSTALLATION COMPLIANCE:** Galvin Engineering products must be installed in accordance with these installation instructions and in accordance with AS/NZS 3500, the PCA and your local regulatory requirements. Water and/or electrical supply conditions must also comply to the applicable national and/or state standards. Failing to comply with these provisions shall void the product warranty and may affect the performance of the product.

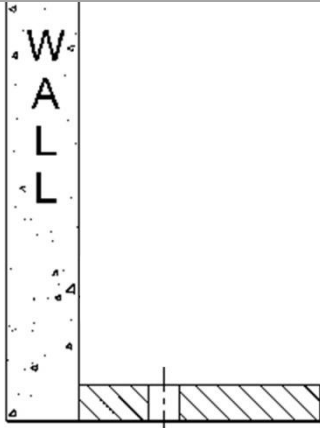

### 1. Prepare the bench

- Measure the distance between the wall mounting surface and the centre line of the drilled hole in the bench/trough
- Drill as per specification

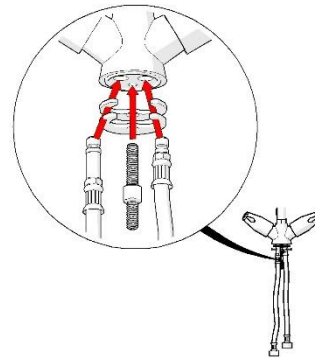

### 2. Fit assembly

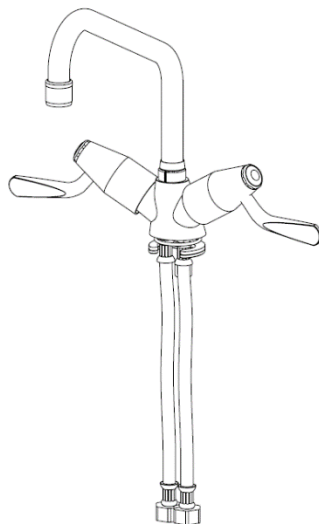

- Fit compression nut to support rod, followed by the compression cone and locate the support rod into wall bracket.
- Fit the two supplied flexi hoses into the body.
- Fit the mixer body through the drilled hole in the bench. Secure body with supplied stud nut, ensuring to use rubber and 'C' washer.



### 1. Test unit

- Once all fittings have been tightened securely, connect the unit to the mains water.
- Turn on water and test the unit for any leaks.

## WARNINGS

-  For optimum performance it is recommended that the isolation or mains taps are turned off whilst the unit is not in use (overnight etc.), so that the unit is not under mains pressure when unsupervised. Flood damage may occur if a failure occurs whilst the unit is under mains pressure (warranty is void in this instance).
-  Galvin Engineering recommends that the handpiece is periodically serviced by a qualified plumber.
-  **IMPORTANT:**  
*To seal the hose this unit uses Loctite 577 which is a thread sealant approved for use with potable water (AS/NZS 4020). If hose is to be removed for maintainance purposes, reseal the joints with Loctite 577, or an equivalent sealant compliant with AS/NZS 4020. Do not use thread tape to seal the hose connections, as this may cause the hose nut to become loosened over time and leak.*

## WARRANTY

Galvin Engineering products are covered under our Manufacturer's Warranty. Galvin Engineering products must be installed in accordance with the installation instructions and in accordance with AS 3500 and NCC Volume Three, relevant Australian Standards and local authorities applicable to product being installed. Water and electrical supply conditions must also comply to the applicable national and/or state standards, failing to comply with these provisions may void the product warranty and affect performance of the product.

Please visit [www.galvinengineering.com.au](http://www.galvinengineering.com.au) to view the full warranty, our Installation Compliance and Maintenance & Cleaning information as well as any other additional information.

Within Australia: 1300 514 074 Outside Australia: P: +61 (0)8 9338 2344

F: +61 (0)8 9338 2340

[sales@galvinengineering.com.au](mailto:sales@galvinengineering.com.au)

[www.galvinengineering.com.au](http://www.galvinengineering.com.au)

ABN: 78 008 719 382

PERTH | SYDNEY | MELBOURNE | BRISBANE | ADELAIDE

